

Poly Cord

PCS2 – Poly Cord

STANDARD FEATURES

- Manufactured in USA
- **Tray application only**
- Tight 90 degree turns, min. 18" centerline radius
- UHMW Guide blocks direct the travel of the Poly Cord
- All 304 stainless steel construction with a #4 finish
- Table top is constructed from 14 gauge stainless steel
- Low maintenance and sanitary design
- 1/2 horsepower variable speed wash down duty drive motor
- Poly cord return underneath table
- Adjustable speed control through AC inverter in a NEMA 4 control cabinet
- Drive motor supplied as in-line or at the end of the tabling
- Unit supported on 1-5/8" diameter 16 gauge wall polished stainless steel tubular legs with *fully welded* 1-5/8" cross bracing
- Low Amp draw – requires only 15 Amp breaker with 208/60/1
- Cord is 12 mm in diameter
- Poly cord weld kit included



DURABLE CORD DESIGN

12mm high strength polypropylene cord with woven nylon cord reinforcement.

SPECIFIER STATEMENT

Every system is designed, built and tested by the same team, ensuring the highest of quality. The Bi-Line Poly Cord is perfect for tray applications. Its exposed cord makes clean-up very easy and is economical in use. UHMW plastic guides increase the cord and tabling's life, while a standard waterproof drive motor resists water spray. A variable speed control is standard in a NEMA 4 rated control panel.

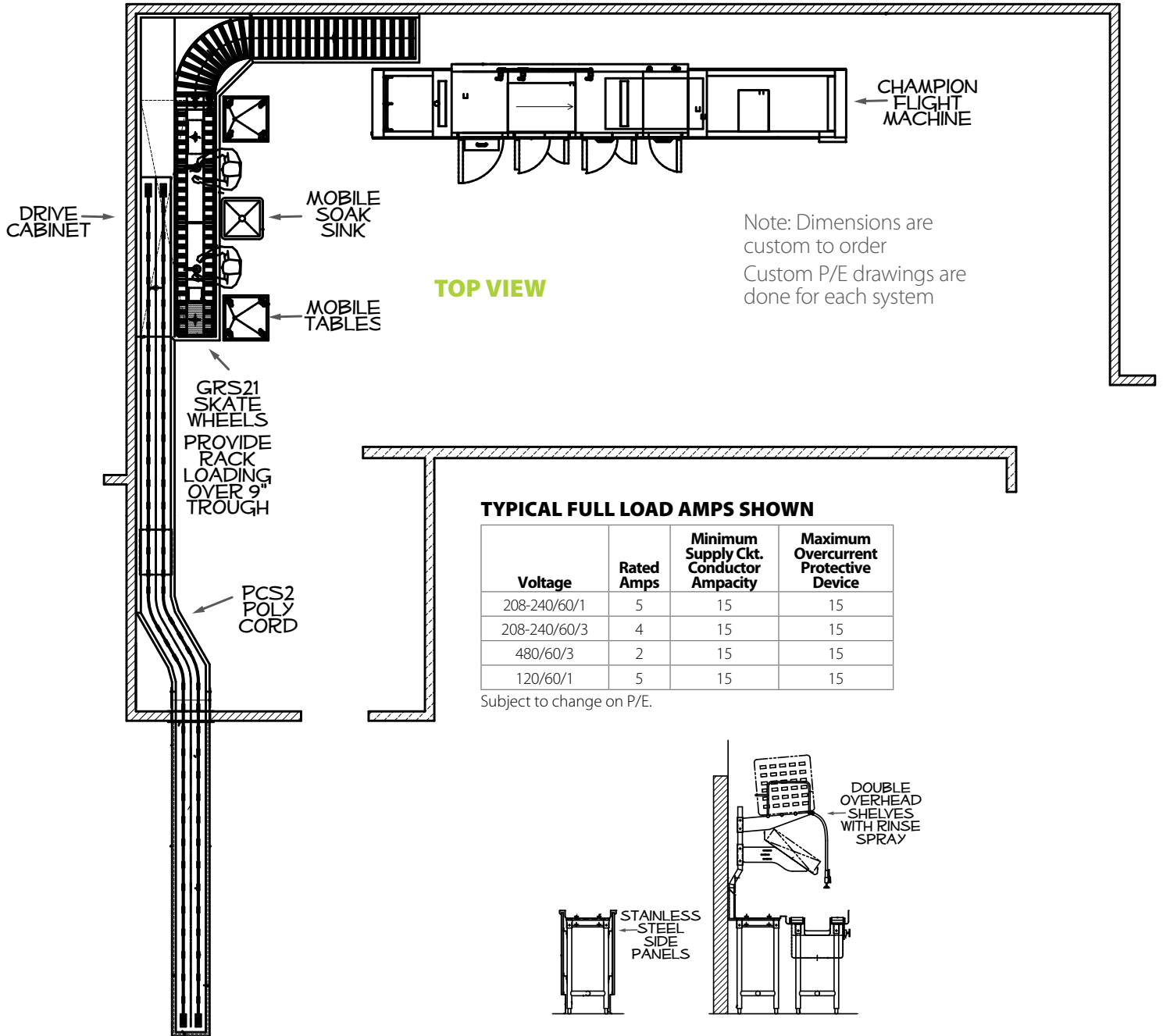

**SIDE VIEW
DROP OFF**

**SIDE VIEW
SCRAPPING
TABLE**

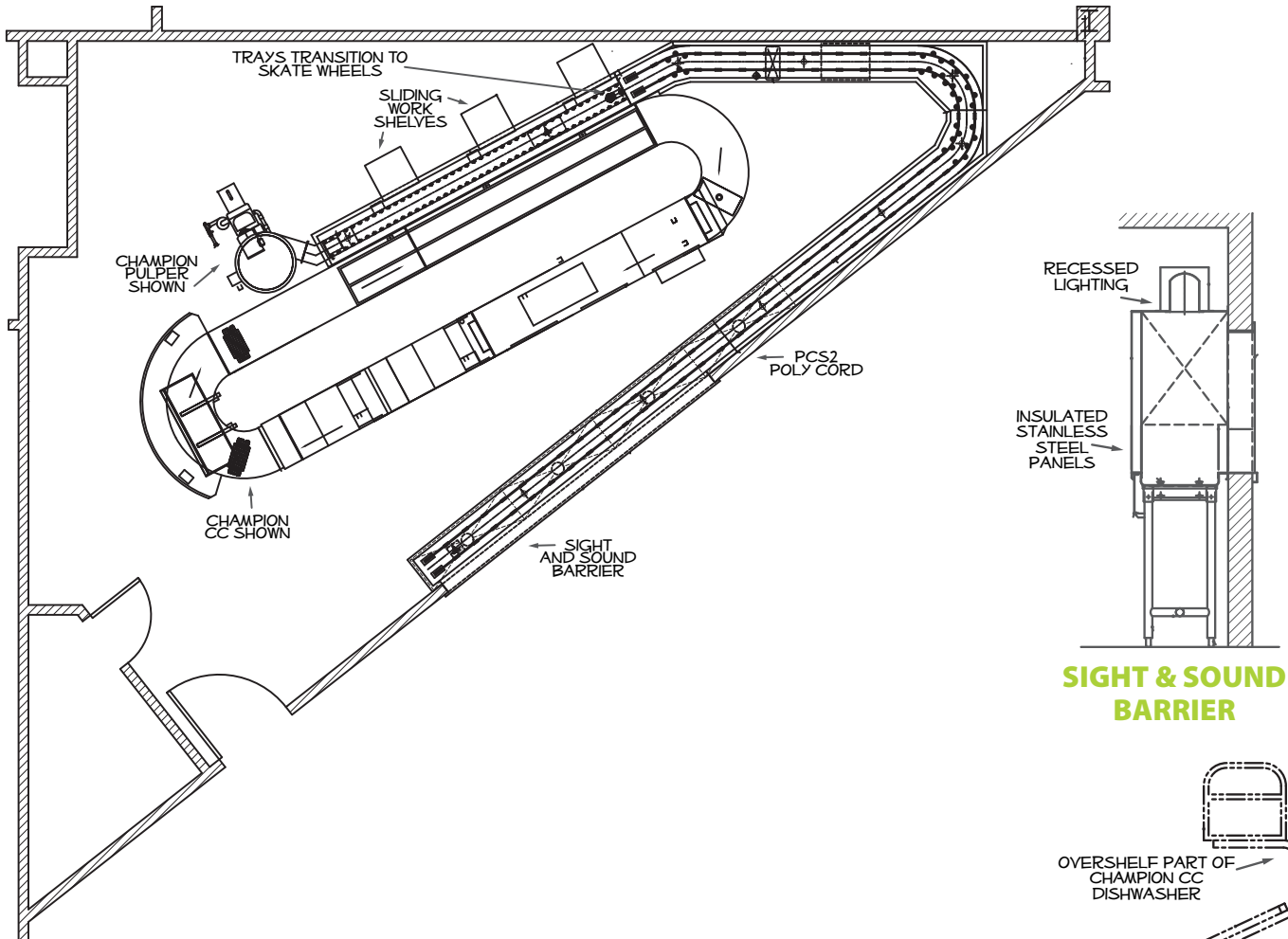

SIGHT & SOUND BARRIER

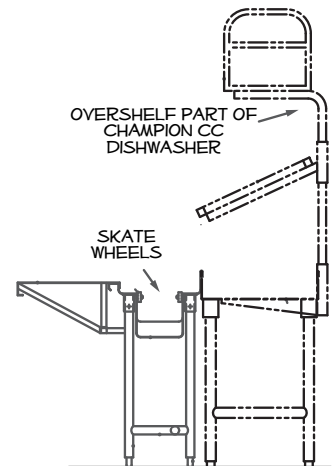

TROUGH SECTION VIEW

TYPICAL FULL LOAD AMPS SHOWN

Voltage	Rated Amps	Minimum Supply Ckt. Conductor Ampacity	Maximum Overcurrent Protective Device
208-240/60/1	5	15	15
208-240/60/3	4	15	15
480/60/3	2	15	15
120/60/1	5	15	15

Subject to change on P/E.

Note: Dimensions are custom to order
Custom P/E drawings are done for each system



OPTIONS & ACCESSORIES

- Custom size and shape per plan
- Single over-shelf
- Double over-shelf
- Hip/Palm advance button
- Foot advance switch
- Integral trough
- Mobile tables
- Pre-rinse sink with rinse spray
- Sliding work shelves
- Limit switch – mechanical
- Limit switch – photo eye
- Seismic bolt down feet
- Extra length of cord
- Mobile soak sink
- Laminated or stainless steel panels for exposed belt at customer drop off
- Sight and sound barrier with recessed lights
- Skate wheels (for trough)
- Wash down hose reel
- Trough magnets
- Trough bridges
- Disposer cover for trough
- Trough, silver saver, sink



wash down duty drive motor



Poly Cord with UHMW guide blocks and wheels



Control panel with variable speed control